

# **FREEZY** *CONDENSATE REMOVAL SYSTEM*

## **INSTALLATION INSTRUCTIONS**

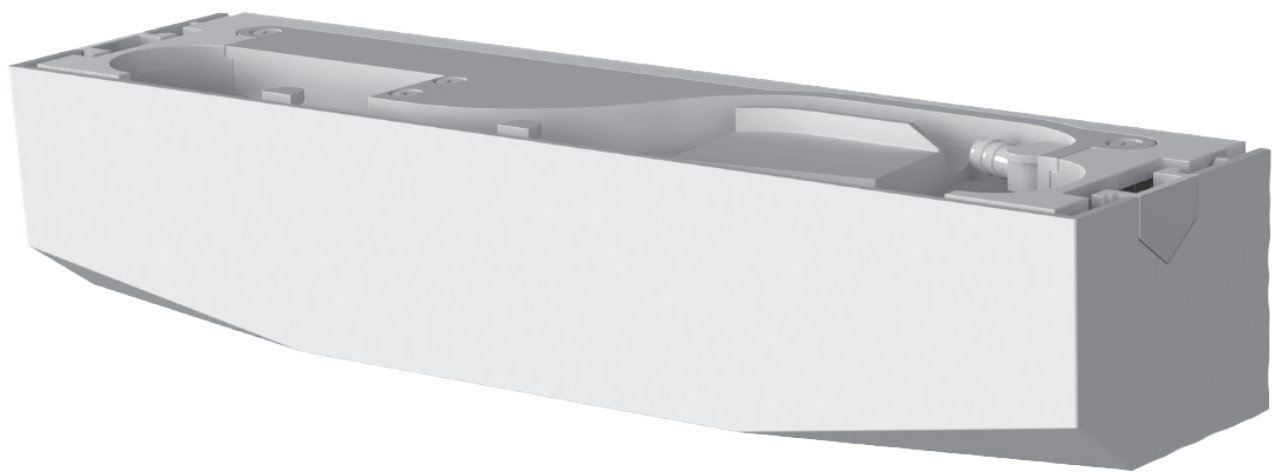

READ THIS MANUAL IN ITS  
ENTIRETY PRIOR TO INSTALLATION.



DISCONNECT POWER  
BEFORE SERVICING.

## PACKAGE CONTENTS:

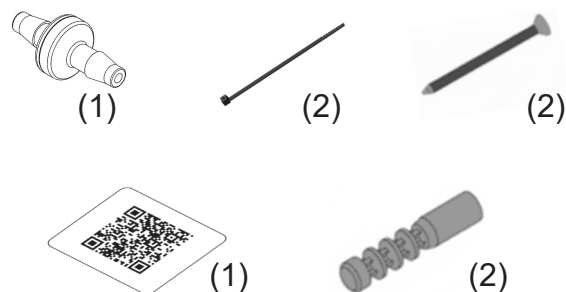
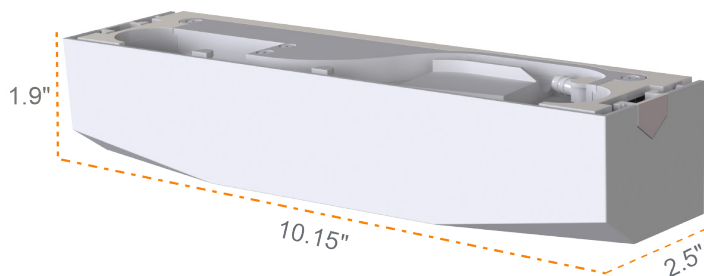

## TECHNICAL DATA:

PART NUMBER	FREEZY
MAX FLOW RATE	5.3 GPH
MAX HEAD	33'
SOUND	<19 dB
VOLTAGE	110 OR 240V 50/60 HZ
ALARM RELAY	NO/NC 8A 110-240VAC
DISCHARGE TUBE	1/4" ID
SUCTION	SELF PRIMING
COLOR	WHITE
THERMAL PROTECTION	UP TO 212°F
INSTALLATION RANGE	6,000-54,000 BTU/H

## PERFORMANCE DATA:



## INSTALLATION TIPS:

TO ENSURE ULTRA-QUIET, EFFICIENT FUNCTIONALITY, TAKE EVERY PRECAUTION TO AVOID KINKING IN THE CONDENSATE DRAIN.

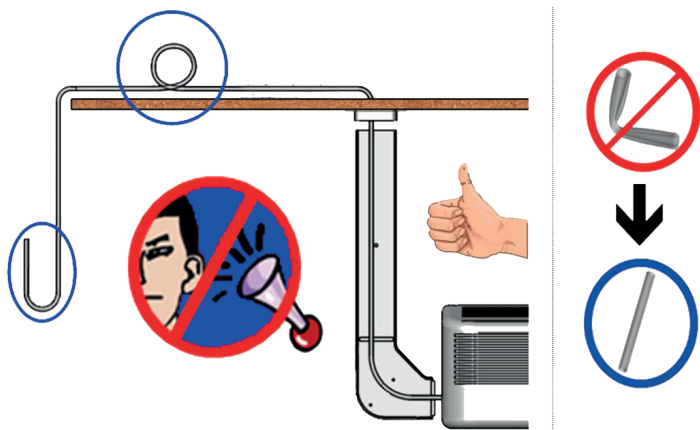

## RECOMMENDED MAINTENANCE:



**WARNING**



### DISCONNECT POWER BEFORE SERVICING

ONCE PER YEAR, WIPE OUT THE SPACES BELOW, WHICH ARE MARKED IN RED, USING 5% BLEACH AND WATER MIXTURE.

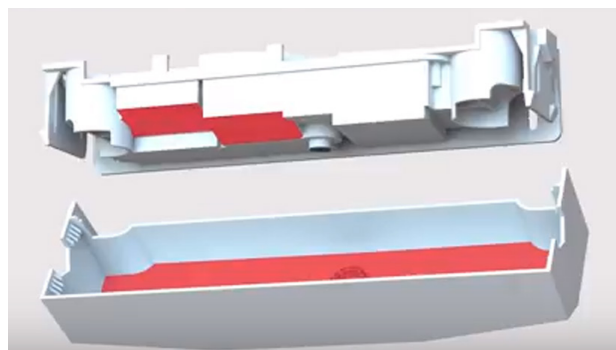

## STEP-BY-STEP INSTRUCTIONS

### STEP 1:

TO REMOVE COVER, PRESS AND HOLD BUTTONS ON EITHER SIDE OF THE UNIT (A & B), THEN SLIDE THE COVER DOWN.

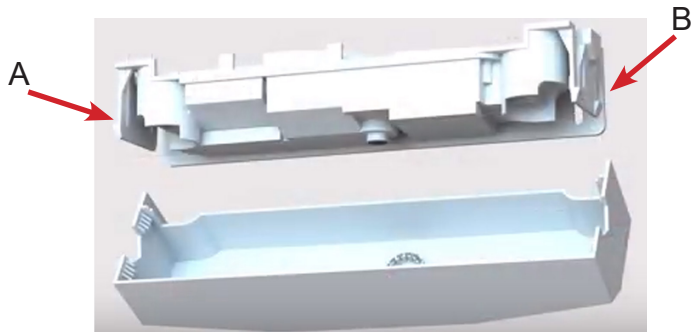

### STEP 2:

WIPE AND CLEAN RED AREAS USING A 5% BLEACH AND WATER MIXTURE.

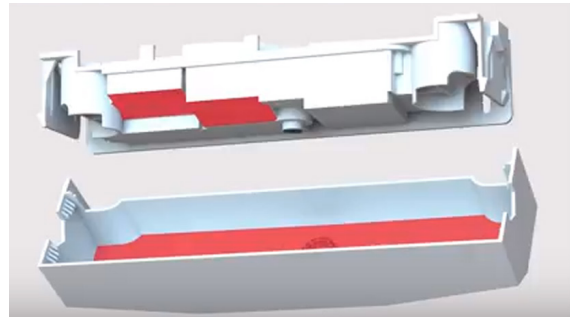

### STEP 3:

THE **FREEZY** PUMP CAN BE INSTALLED UNDERNEATH ANY MINI-SPLIT UNIT ON THE LEFT OR RIGHT-HAND SIDE. BEND THE POWER CABLE AND DRAIN TUBE ACCORDING TO THE DEMONSTRATION BELOW:

*LEFT-SIDE MOUNTING:*



*RIGHT-SIDE\* MOUNTING:*



\*WHEN MOUNTING THE PUMP ON THE RIGHT SIDE OF THE EVAPORATOR, CHECK THAT THE ANTI-PINCH SPRING IS NOT BLOCKED.



HOLD THE **FREEZY** IN DESIRED POSITION AND MARK WALL. THE DESIRED POSITION OF THE SCREWS IS INDICATED BY THE SMALL MARKS ON THE MOUNTING HOLES.

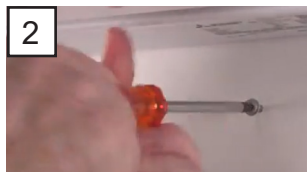

INSERT SCREWS, LEAVING ENOUGH SPACE FOR THE **FREEZY** TO SLIDE OVER THE TOP - ABOUT 1/2".



SLIDE THE **FREEZY** OVER THE SCREWS AND INSERT CONDENSATE DRAIN HOSE INTO THE UNIT.



SLIDE THE UNIT UP AND TIGHTEN SCREWS FIRMLY.

### STEP 4:

CONNECT THE PUMP HOSE WITH THE DRAIN HOSE BY USING THE CHECK VALVE AND SECURE THE CONNECTIONS WITH THE PROVIDED ZIP TIES.

**!! MAKE SURE THE CHECK VALVE IS FACING THE RIGHT WAY !!**

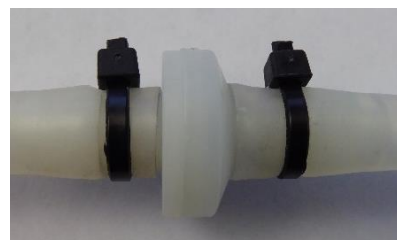

## STEP 5:

FEED THE ELECTRICAL CABLE THROUGH THE HOLE OF THE MINI-SPLIT INDOOR UNIT IN THE EVAPORATOR. ADJUST THE LENGTH AND POSITION OF THE DRAIN PIPE IN ITS HOUSING.

LEFT-SIDE MOUNTING:



RIGHT-SIDE MOUNTING:



**WARNING:** POSITIONING DRAIN LINE TOO SHORT INTO THE HOUSING WILL CAUSE WATER TO ENTER OUTER ELECTRONICS.

## STEP 6:

PUSH THE PUMP AGAINST THE EVAPORATOR AND TIGHTEN THE SCREWS.

PROCEED TO THE ELECTRICAL CONNECTIONS, FOLLOWING THE ELECTRICAL SCHEMATIC.

POWER:

BLACK = PHASE, WHITE = NEUTRAL

GREEN/YELLOW = EARTH

ALARM: GREY = COMMON, VIOLET = NC, ORANGE = NO

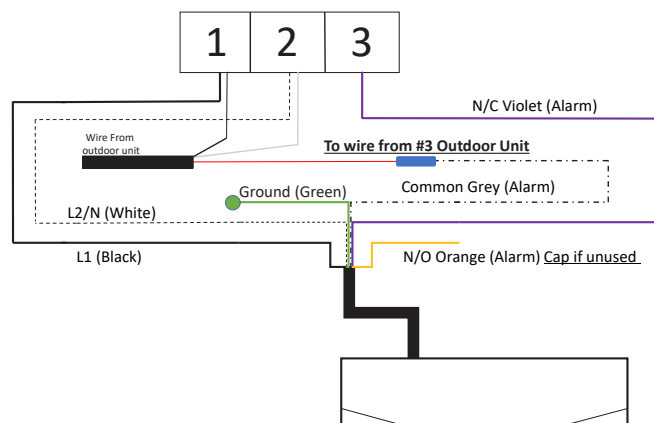

## STEP 7:

INSTALL THE RESERVOIR ON THE LOWER CLIP AND FILL IT WITH 3-5 OUNCES OF WATER.

REPLACE THE COVER, BY SLIDING IT UP AND OVER THE MOUNTED UNIT UNTIL YOU HEAR THE BUTTONS CLICK.

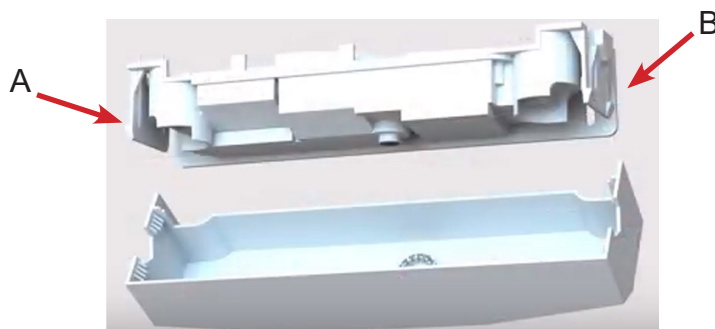

IF THE PUMP DOES NOT ENGAGE, CHECK ELECTRICAL CONNECTIONS.

**FOR A FULL INSTALLATION VIDEO, SCAN THE QR CODE IN THE ACCESSORY BAG.**